

Basic Single Stub Tuner

GERLING

Model GA1023
Model GA1024
Model GA1025

GAE's family of Basic Stub Tuners provide an economical means for load impedance matching in high power microwave heating systems. Their simple yet rugged design makes these tuners ideal for a variety of production and OEM applications.

The Basic models have threaded stub mounts and spring-loaded nuts which maintain secure thread engagement at all times, enabling stub adjustment during microwave power operation. These are intended mainly for low-Q applications or where adjustments are infrequent. For high-Q applications or where impedance matching adjustments are frequent we recommend our Precision series of waveguide stub tuners.

Single stub tuners are a convenient and low cost option for applications in which the ideal impedance matching stub location is predetermined, or as a tool during product development to help find the ideal location.

General Specifications:

Waveguide	GA1023: WR284 GA1024: WR340 GA1025: WR430
Flange	GA1023: UG1725/U GA1024: UG554/U GA1025: UG437B/U (all with 1/4-20 UNC tapped holes)
Frequency	2450 MHz +/- 50 MHz nominal
Power (continuous)	GA1023: 3 kW GA1024: 6 kW GA1025: 10 kW
Construction	Aluminum waveguide, brass stubs
Finish	Chemical conversion coating (waveguide)

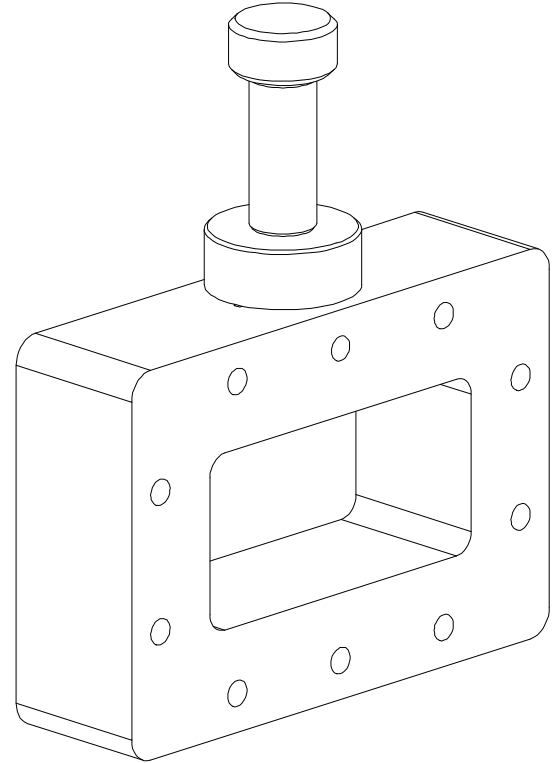

Model GA1024

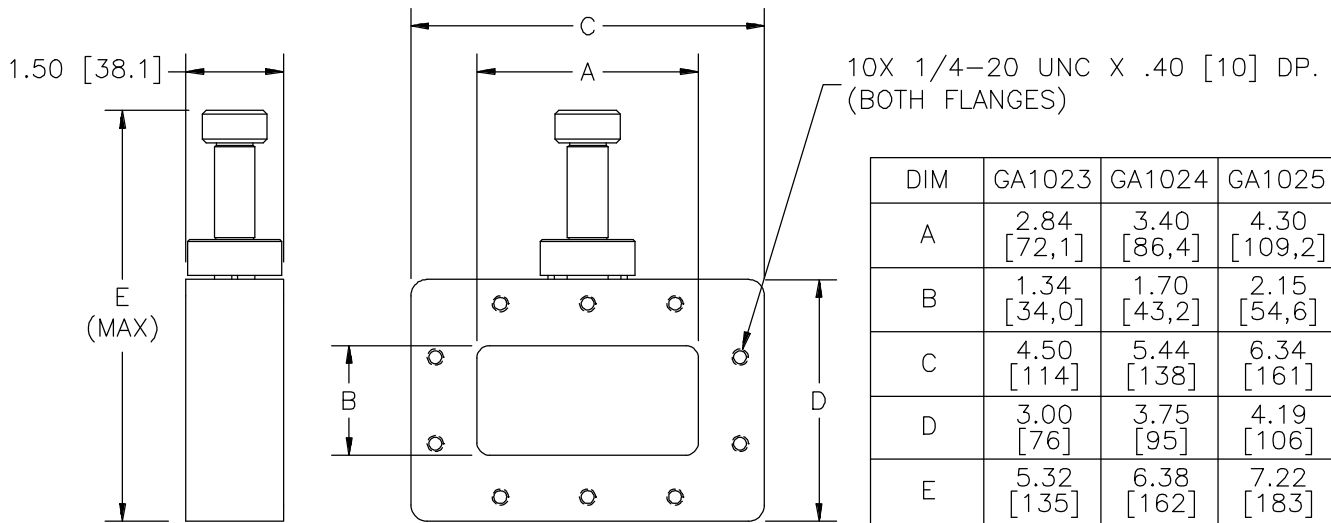

**GERLING APPLIED
ENGINEERING, INC.**

© 2010 Gerling Applied Engineering, Inc.
 PO Box 580816 • Modesto, CA 95358 • USA
 Phone: +1-209-527-8960 • Fax: +1-209-527-5385
 E-mail: sales@2450MHz.com • Web: www.2450MHz.com

All dimensions are in inches [millimeters].

Updated 18NOV10