

Flange Adapter, WR284 Round (Cover) to CPR

GERLING

Model GA2404

The GA2404 Flange Adapter provides a simple and low cost means to convert standard rectangular CPR style flanges on WR284 waveguide components to the standard round style (UG584/U). Tapped thru holes are provided for both flange patterns which can be specified with either 1/4-20 UNC (by default) or M6 metric threads.

The GA2404 is a high quality, precision machined aluminum for enhanced performance and durability.

General Specifications:

Waveguide	WR284 (RG75/U)
Pattern 1	UG584/U (Round)
Pattern 2	UG1725/U (CPR284F)
Mounting Holes	1/4-20 UNC thru (both flanges)
Input VSWR	1.02:1 max.
Insertion Loss	.01 dB max.
Construction	6061-T6 aluminum
Finish	Chemical conversion coating

Options:

- ◆ M6 metric threads (add "M" suffix to model number)
- ◆ Alternate thread sizes
- ◆ Interlock switch
- ◆ Alternate finish

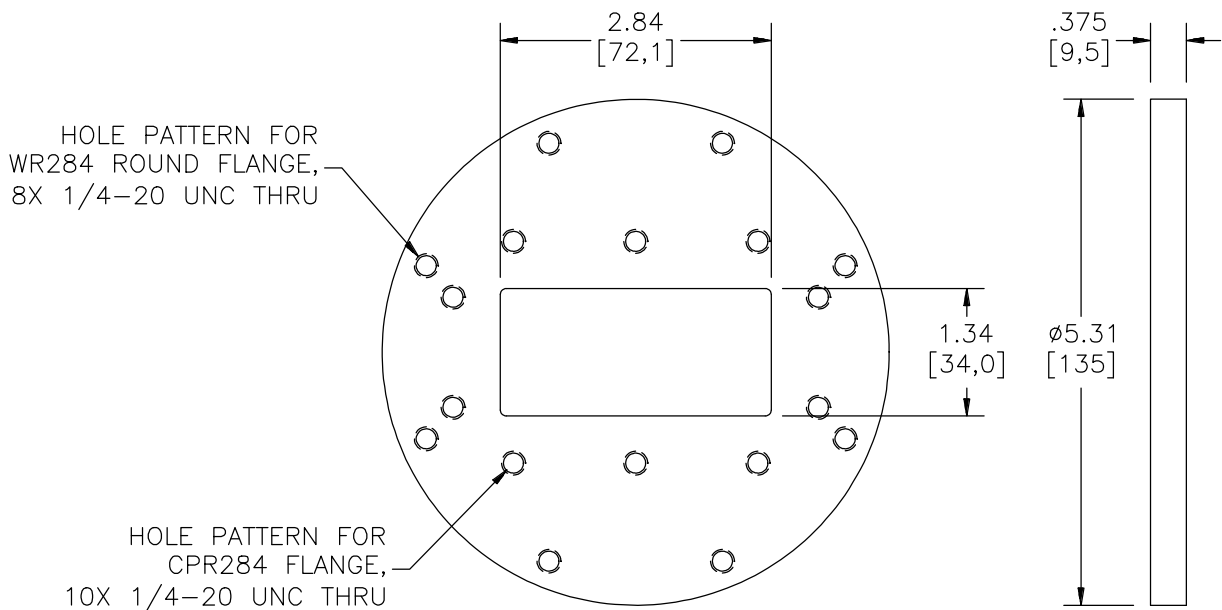
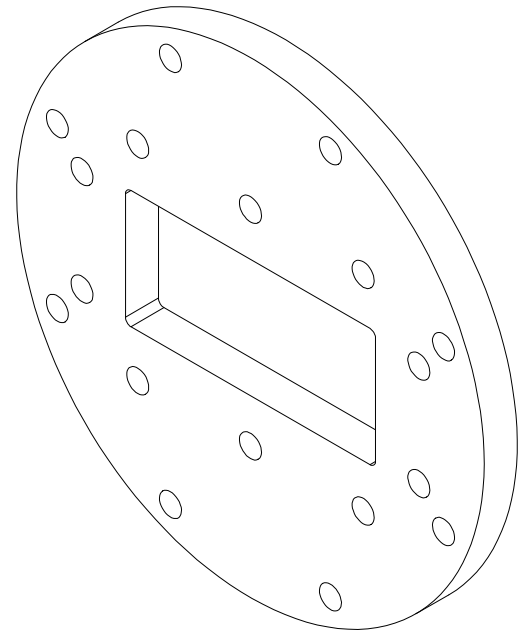

GERLING APPLIED
ENGINEERING, INC.

© 2003 Gerling Applied Engineering, Inc.
PO Box 580816 • Modesto, CA 95358 • USA
Phone: +1-209-527-8960 • Fax: +1-209-527-5385
E-mail: sales@2450MHz.com • Web: www.2450MHz.com